

This literature was published years prior to the establishment of Agilent Technologies as a company independent from Hewlett-Packard and describes products or services now available through Agilent. It may also refer to products/services no longer supported by Agilent. We regret any inconvenience caused by obsolete information. For the latest information on Agilent's test and measurement products go to:

www.agilent.com/find/products

Or in the U.S., call Agilent Technologies at 1-800-452-4844 (8am-8pm EST)



Agilent Technologies

Innovating the HP Way



mm-Wave Waveguide Isolators

50.0 - 110.0 GHz

HP Models
V 365A
W 365A

TECHNICAL DATA · JULY 1986

NEW PERFORMANCE STANDARDS FOR mm WAVE MEASUREMENTS

Isolators are important measurement accessories for isolating reflections and reducing mismatch.

HP's V and W365A Isolators are ideal measurement isolators. In a measurement, their high, broadband isolation (better than 25 dB) minimizes the reflection effects of a source. Their low SWR and low insertion loss help to improve mismatch inaccuracy without the attenuation of matching pads.

The HP V and W365A use a Faraday-rotation design. It consists of a section of waveguide containing low-loss ferrite material and impedance matching elements. A permanent magnet supplies the external magnetic bias field to the ferrite core.

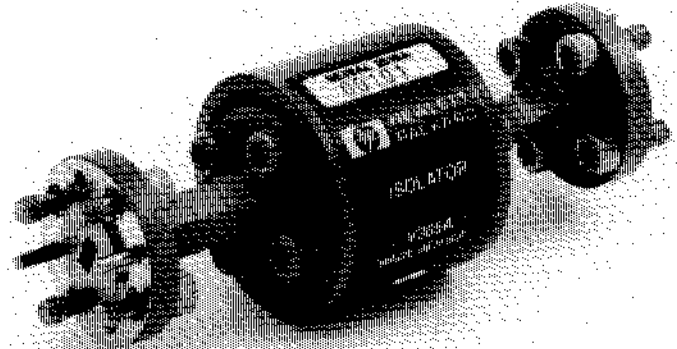

SPECIFICATIONS

HP Model #	V365A	W365A
Frequency Range (GHz)	50.0 - 75.0	75.0 - 110.0
Insertion Loss (dB, max.)	2.0	2.5
Isolation (dB, min.)	25	25
SWR (max.)	1.5	1.5
Maximum Input Power (W, avg.)	1.0	1.0
Fits Waveguide Size:		
EIA	WR-15	WR-10
MIL-W-85/x-xxx	3-017	3-023
Equivalent Flange:		
MIL-F-3922/xxx-xxx	67B-008	67B-010
UG-xxx/U	UG-385/U	UG-387/U (mod.)
Dimensions:		
Length:	cm. (in.)	6.2 (2.6)
Diameter:	cm. (in.)	2.5 (1.0)
Net Weight:	gm. (lb.)	68 (.15)

Isolator

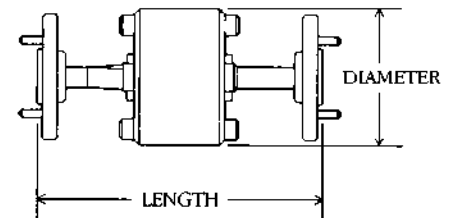

For more information, call your local HP sales office listed in the telephone directory white pages. Ask for the Electronic Instruments Department. Or write to Hewlett-Packard: **U.S.A.** — P.O. Box 10301, Palo Alto, CA 94303-0890. **Europe** — P.O. Box 999, 1180 AZ Amstelveen, the Netherlands. **Canada** — 6877 Goreway Drive, Mississauga, L4V 1M8, Ontario. **Japan** — Yokogawa-Hewlett-Packard Ltd., 3-29-21, Takaido-Higashi, Suginami-ku, Tokyo 168. Elsewhere in the world, write to Hewlett-Packard Intercontinental, 3495 Deer Creek Road, Palo Alto, CA 94303-0890.

5954-7353

Data Subject to Change

Printed in U.S.A.